

Sta	Course	Angle	Sta	Course	Angle	Sta	Course	Angle
337+26.0	N34°06'E	18	301+36.0	S72°22'E	7	421+30.0	S87°22'W	40
339+62.0	N35°56'E	19	302+90.0	S89°27'E	8	422+00.0	M.P.	
340+28.4	N46°08'E	20	303+20.0	N55°26'E	9	423+24.1	S84°00'W	1
341+58.2	N51°09'E	21	304+91.3	N32°21'E	10	424+06.1	N70°05'W	2
342+17.2	N52°57'E	22	305+08.1	N32°58'E	11	425+17.2	N61°58'E	3
343+98.0	N44°45'E	24	306+20.0	N12°34'E	12	426+37.0	N40°11'W	4
347+07.0	N24°02'E	25	306+30.0	N6°04'E	13	426+15.2	N13°31'W	5
348+26.3	N50°47'E	26	301+91.1	N3°50'W	14	428+07.1	S83°15'W	7
349+06.2	N1°42'E	27	302+40.0	N12°38'W	15	429+58.7	S82°40'W	8
350+06.0	N6°32'E	28	304+28.1	N26°37'W	16	430+38.5	S59°08'W	9
353+40.0	N3°09'W	29	305+64.0	N52°24'W	17	431+71.0	N66°37'W	10
354+57.6	N30°19'W	30	306+64.0	N64°10'W	18	432+52.9	N22°30'E	11
355+16.4	N8°11'E	31	308+07.5	N61°01'W	19	434+15.3	N36°01'W	12
356+20.0	N34°23'E	32	309+25.0	N4°23'W	20	435+11.1	N72°06'W	13
358+07.0	N42°37'E	33	400+35.0	N20°48'W	21	435+53.2	N74°01'W	14
359+08.0	N49°29'E	34	403+01.0	N47°47'W	22	436+07.0	S82°06'E	15
360+80.0	N39°15'E	35	404+41.0	N54°08'W	23	438+18.0	N42°47'W	16
361+59.0	N29°40'E	36	406+42.0	N59°30'W	24	439+41.0	N77°37'W	17
362+46.0	N21°00'E	37	408+08.1	N1°20'E	26	440+61.5	N48°59'W	18
363+38.5	N38°27'E	38	409+09.1	N54°49'E	26	442+07.5	N19°23'E	19
364+81.7	N30°37'E	39	410+98.0	N3°08'E	27	443+08.5	N24°32'E	20
366+59.0	N7°29'E	40	411+65.1	N48°44'W	28	444+18.0	N17°37'E	21
366+97.5	N50°35'E	41	412+31.0	S81°27'W	29	445+36.7	N41°57'E	22
367+90.0	N51°41'E	42	413+27.0	N43°53'W	30	445+76.0	N36°18'E	23
369+22.0	N72°43'E	43	413+60.0	N13°02'E	31	447+21.2	N45°58'E	24
369+60.0	M.P.		414+89.4	N25°44'W	32	448+18.5	N46°59'E	25
370+06.0	N46°30'E	10	415+01.1	S87°22'W	33	448+47.0	S75°34'W	26
372+06.0	N20°17'E	1	415+04.0	N45°47'W	34	447+08.5	N29°08'W	27
373+16.0	N21°49'E	2	416+76.1	N49°14'W	35	449+33.2	N16°00'E	28
375+04.5	N31°04'E	3	417+91.0	N61°58'W	36	449+64.0	R.T.	
377+76.0	N10°06'E	4	418+38.7	N40°18'W	37			
379+06.0	N71°30'E	5	419+62.0	S61°44'W	38			
380+27.0	S83°34'E	6	420+69.0	N68°13'W	39			

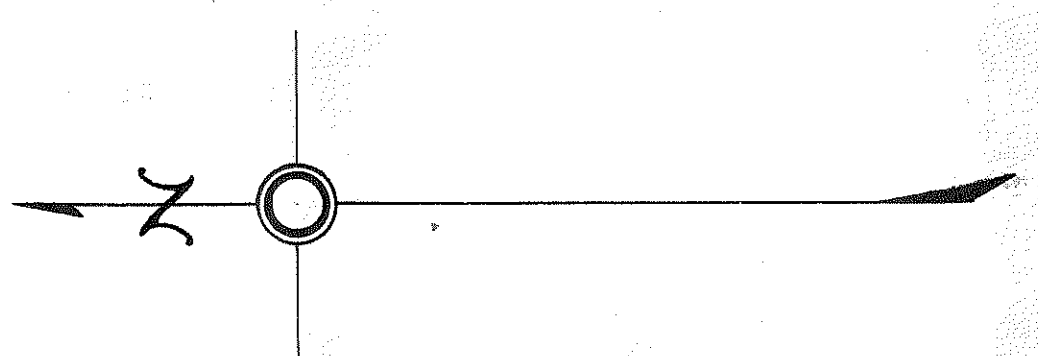
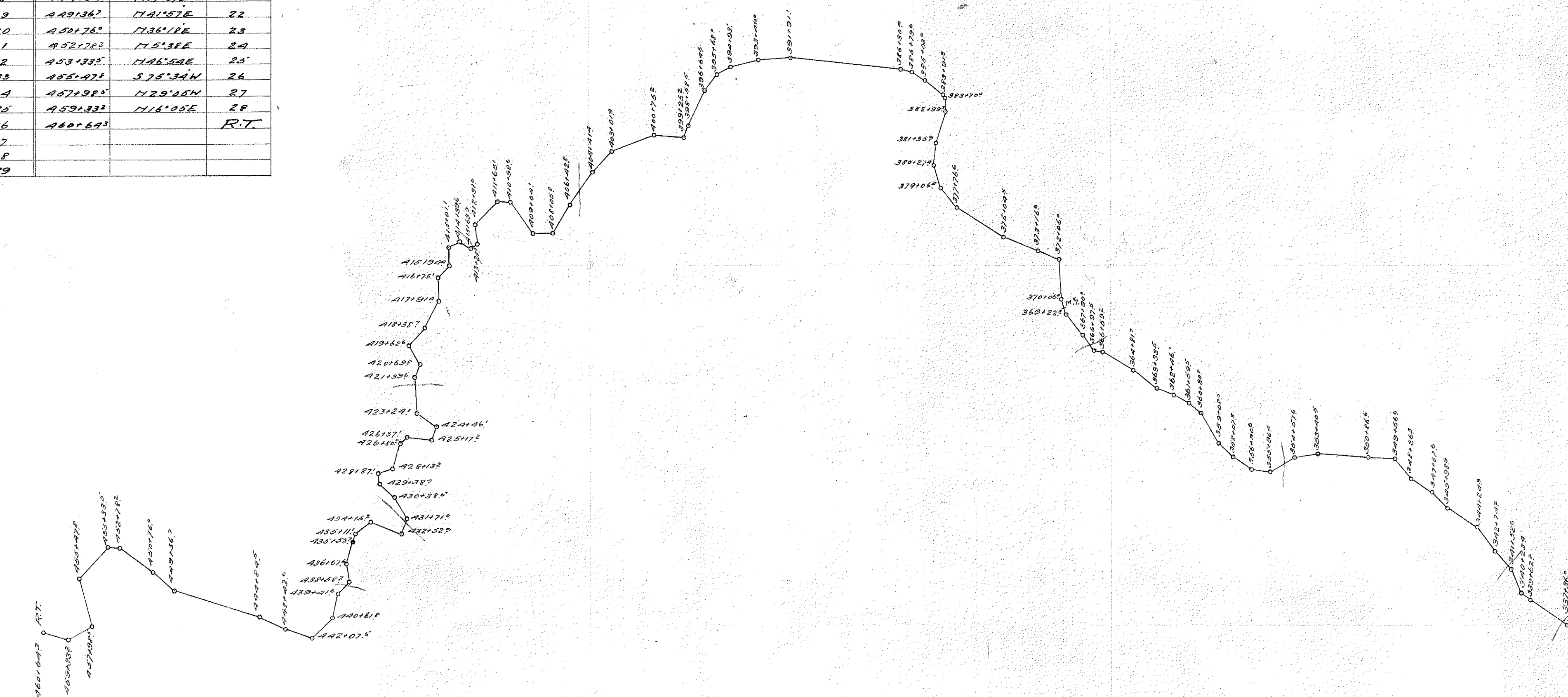

MAP
OF
NECARNEY M.T.C.O ROAD
NEHALEM CITY TO GLATSCOP CO LINE
SECS. 5, 6, 7 T3 N, R10 W.
U. G. Jackson CO SURV. July, 1913.
SCALE 1"=400'
SHEET N°3.