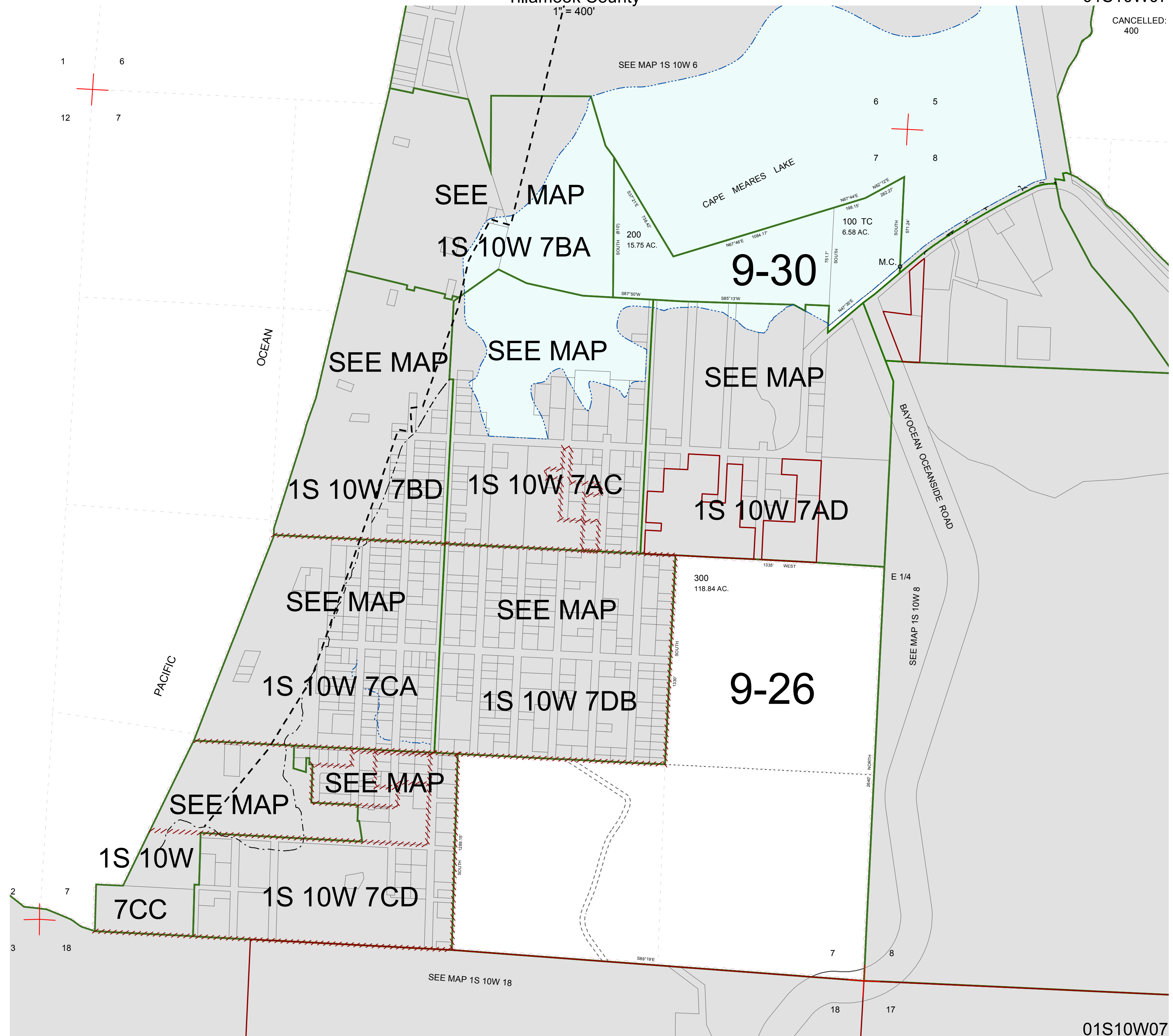

FOR ASSESSMENT AND TAXATION ONLY, NOT SUITABLE FOR
LEGAL, ENGINEERING, OR SURVEY PURPOSES

SECTION 7 T.1S. R.10W. W.M.
Tillamook County

01S10W07

CANCELLED:
400

01S10W07
REVISED 2/18/16, WS