

THIS MAP WAS PREPARED FOR  
ASSESSMENT PURPOSE ONLY

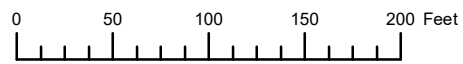

N.W.1/4 S.W.1/4 SEC.2 T.2N. R.10W. W.M.

TILLAMOOK COUNTY

02N10W02CB

WHEELER

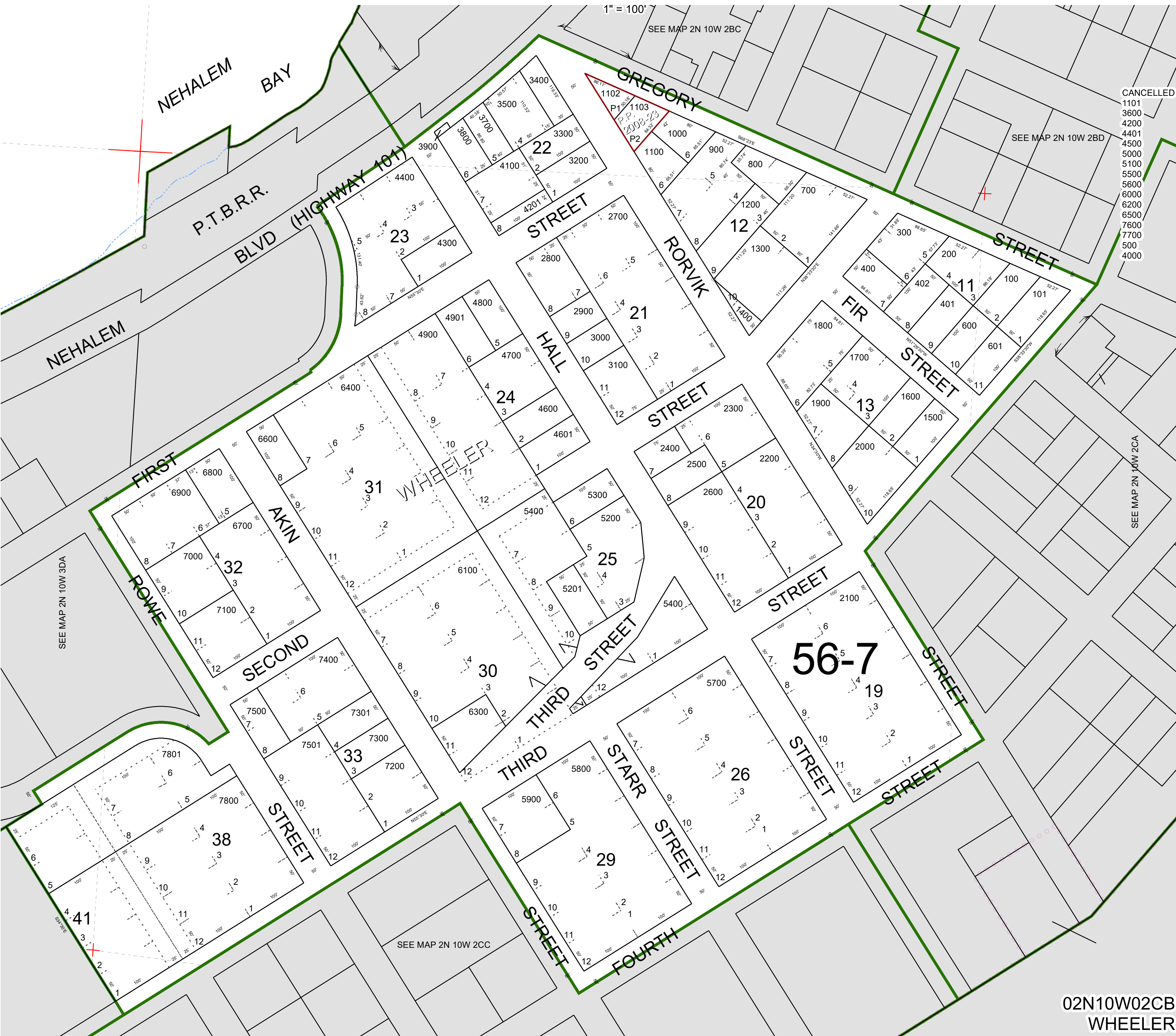

02N10W02CB

WHEELER

Revised 8/20/24, WS