



Kilchis River County Campground



Amenities Include:

- On Site Park Hosts
- RV/Tent Sites
- Playground
- Group Picnic Areas
- Coin-Operated Showers
- Day Use/River Access
- Bank Fishing & drift boating
- Swimming & hiking

Reservations:

(503) 322-3522

Online at:

<http://reservations.co.tillamook.or.us>

Open year round

Summer Rates: May - Sept

Winter Rates: Oct - April



KILCHIS RIVER COUNTY CAMPGROUND

Reservations:

(503) 322-3522

Online at: reservations.co.tillamook.or.us

parks@co.tillamook.or.us

www.co.tillamook.or.us/gov/parks

Mailing Address:

Tillamook County Parks Dept.

PO Box 633

Garibaldi, OR 97118

Physical Address:

10500 Kilchis River Road

Tillamook, OR 97141

- Brown Sites
- Blue Sites
- Host Sites

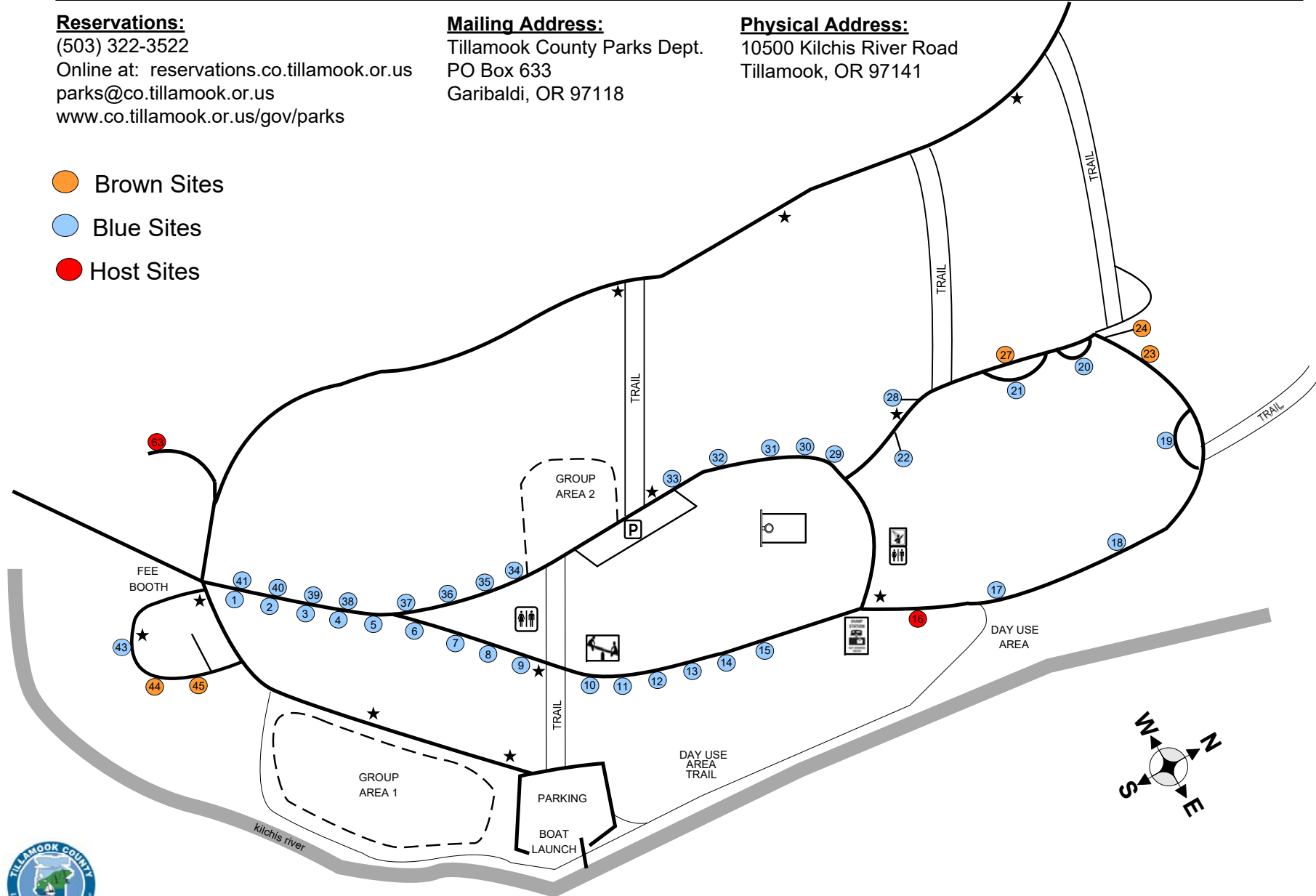

- Restrooms
- Water
- Showers
- Extra Vehicle Parking
- Playground

KILCHIS RIVER COUNTY CAMPGROUND/PARK
Fee Structure, Site Limitation and Reservation Policy
Effective November 1st, 2018

THE COST BELOW INCLUDE AN 11.5% LODGING TAX

Transaction Fee..... \$11 per Registration
A one-time non-refundable fee charged on each site for all Reservations & Same Day registrations.

BROWN Site Marker: Summer Base Rate \$22/night
..... Winter Base Rate \$16/night
Allows one tent and one vehicle. One extra vehicle may be added for \$10 per night. Extra tents are not allowed. No recreational vehicles. No car camping. Tent area is 10' x 10'. Campsite limit is 6 people.

BLUE Site Marker : Summer Base Rate \$27/night
..... Winter Base Rate \$22/night
Allows one tent and one vehicle . One extra tent may be added for \$8 per night. One extra vehicle may be added \$10 per night. Tent area is two 10' x 10' tent areas. Campsite limit is 10 people.

Group Picnic Area: Base Rate \$55/day
..... \$11 non-refundable Transaction fee
Reservations are available for Group Picnic Areas. Reservations May thru September. Group Picnic Area Reservations include 25 vehicle passes. Additional vehicles will be charged \$10.00 Day Use Fee.
**Parking is limited – Please carpool where possible.*

Day Use Area Parking: Base Rate \$10/per day per vehicle
A daily pass is valid for the entire day at any Tillamook County Parks Department Day Use Facility for day-use parking. (A daily pass is also valid for day-use parking at any other Tillamook County Parks Dept. Day Use Facility during the entire day in which the pass was purchased).

Hiker-Biker: Base Rate \$9/night
Allows one person and one tent. One extra person may be added for \$9 per night. Campsite limit is one small tent and two people. No vehicles. Tent area is smaller than 10x10. For people-powered travelers only.

RV Holding Tank Dump: Base Rate \$10/RV
Allows one RV, not registered as a park guest, to empty the contents of an RV's holding tank.

Pet Fee..... \$6 per Pet/per stay
A single fee charged per pet per stay.

**Summer Rates effective May 1st – September 30th *Winter Rates effective October 1st – April 30th*

Please remove all occupied signs when you leave and remember

CHECK OUT - 1:30 P.M. CHECK IN - 3:30 P.M.

For information or reservations at one of our campgrounds:

reservations.co.tillamook.or.us

(503) 322-3522

Be a part of something special:

www.tillamookcountyparksfoundation.or